

MACCHINE PER IMBALLAGGIO

MACHINES POUR EMBALLAGE
WRAPPING MACHINES

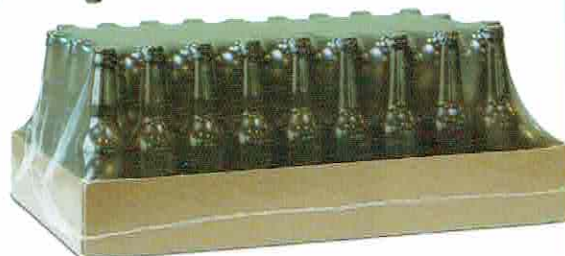
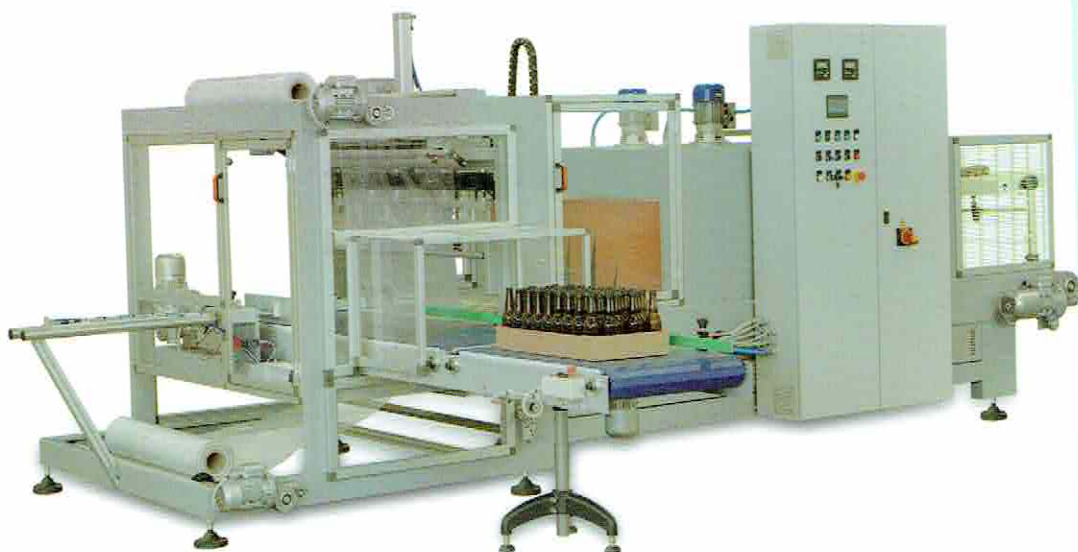

MOD. AND 070 / 150

MOD AND 070/150

+

BM 1407/2015

Linee automatiche, per il confezionamento di qualsiasi prodotto con e/o senza supporto.

Lignes automatiques pour le conditionnement de tous les produits avec ou sans support.

Automatic lines to pack any product with or without support.

Dati tecnici	Données techniques	Technical data	AND					
			070	090	110	130	150	
Barra saldante	Barre de soudure	Welding bar	mm	700	900	1100	1300	1500
Larghezza max bobina	Largeur maxi bobine	Reel maximum width	mm	660	860	1060	1260	1460
Altezza piano di lavoro	Hauteur plan de travail	Working table height	mm			850		
Altezza max confezione	Hauteur maxi emballage	Packing maximum height	mm			380		
Peso macchina	Poids machine	Machine weight	~kg	500	600	650	700	800
Alimentazione pneumatica	Alimentation pneumatique	Pneumatic feeding	atm			7		
Consumo aria compressa per ciclo	Consommation d'air comprimé par cycle	Compressed air consumption per cycle	~NI			29		
Alimentazione elettrica	Alimentation électrique	Electric feeding	Volts		220/380x3 - 50 Hz			
Produzione al min	Production par min	Output/Min		8/12	6/10	4/8	4/8	4/8

			BM 1407 2007 2009 2011 2013 2015						
Peso macchina	Poids machine	Machine weight	~kg	650	850	900	950	1000	1100
Bocca d'entrata	Bouche d'entrée	Inlet door	mm	700x 450	700x 450	900x 450	1100x 450	1300x 450	1500x 450
Potenza elettrica installata	Puissance élec. installée	Set up electric power	KW	21	32	41	45	49	52
Consumo medio energia elettrica	Consommation moyenne énergie électrique	Average electric power consumption	~KW/h	11	16	20	22	23	25

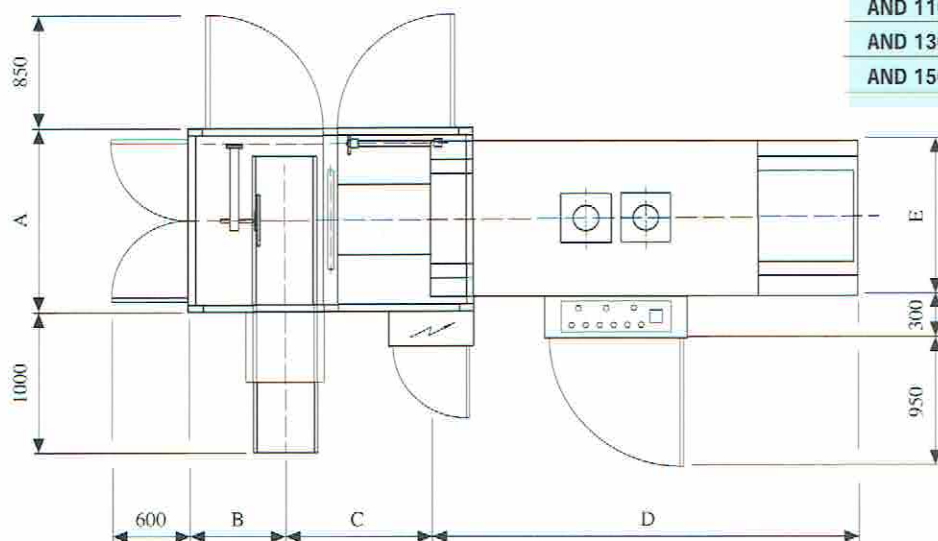

Mod.	
AND 070	A mm 1300 - B mm 700 - C mm 1000
AND 090	A mm 1500 - B mm 700 - C mm 1000
AND 110	A mm 1700 - B mm 700 - C mm 1200
AND 130	A mm 1900 - B mm 700 - C mm 1200
AND 150	A mm 2100 - B mm 700 - C mm 1200

Mod.	
BM 1407	D mm 2500 - E mm 1100
BM 2007	D mm 3000 - E mm 1100
BM 2009	D mm 3000 - E mm 1300
BM 2011	D mm 3/3500 - E mm 1500
BM 2013	D mm 3/3500 - E mm 1700
BM 2015	D mm 3/3500 - E mm 1900



Impianti Novopac s.r.l.

Nuova Zona D3 • Via dell'Automobile, 41 • 15100 Alessandria • Italy
Tel. +39.0131.242111 • Fax +39.0131.240296

www.novopac.it - e-mail: info@novopac.it

Quote non impegnative

Cotes susceptibles de variation
Dimensions not binding